

# POE-PC04S

10/100/1000M Gigabit 802.3af to Passive PoE Converter



## User's Guide

### FCC Certifications

This Equipment has been tested and found to comply with the limits for a Class A digital device, pursuant to part 15 of the FCC Rules. These limits are designed to provide reasonable protection against harmful interference when the equipment is operated in a commercial environment. This equipment generates, uses, and can radiate radio frequency energy and, if not installed and used in accordance with the instruction manual, may cause harmful interference to radio communications. Operation of this equipment in a residential area is likely to cause harmful interference in which case the user will be required to correct the interference at his own expense.

This device complies with Part 15 of the FCC Rules. Operation is subject to the following two conditions: (1) this device may not cause harmful interference, and (2) this device must accept any interference received, including interference that may cause undesired operation.



### CE Mark Warning

This equipment complies with the requirements relating to electromagnetic compatibility, EN 55022 class A for ITE, the essential protection requirement of Council Directive 89/336/EEC on the approximation of the laws of the Member States relating to electromagnetic compatibility.

Company has an on-going policy of upgrading its products and it may be possible that information in this document is not up-to-date. Please check with your local distributors for the latest information. No part of this document can be copied or reproduced in any form without written consent from the company.

Trademarks:  
All trade names and trademarks are the properties of their respective companies.  
Copyright © 2016, All Rights Reserved.



## Unpacking Information

Thank you for purchasing our PoE series products. Before installation, please check that your package contains the following items.

Open the shipping cartons of the converter and carefully unpack its contents. The carton should contain the following items:

1. POE-PC04S Main Unit x 1
2. Warranty Card x 1
3. Quick Installation Guide x 1

### Hardware Overview

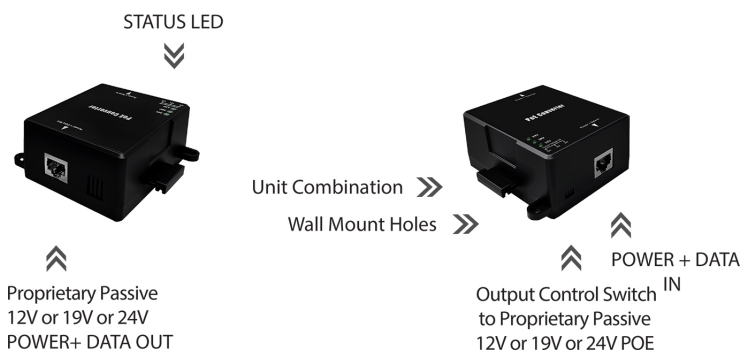

## Introduction

This POE-PC04S can convert the standard 802.3af/at active PoE source to the proprietary passive PoE (power pin 4,5,7,8), in addition it can switchable the volt output to 12V/19V/24V by DIP switch. When there had a standard active PoE switch (802.3af/at) in the network architecture, but the PoE device (PD) is Passive PoE type, then you can use POE-PC04S to convert the PoE power form standard active PoE to proprietary passive PoE, it is very convenient and cost effective solution. It is perfect for transforming access points that use a passive PoE design into 802.3af compliant devices. Other applications also include deploying proprietary passive PoE IP cameras with standard 802.3af/at active PoE switches.

## Product Application

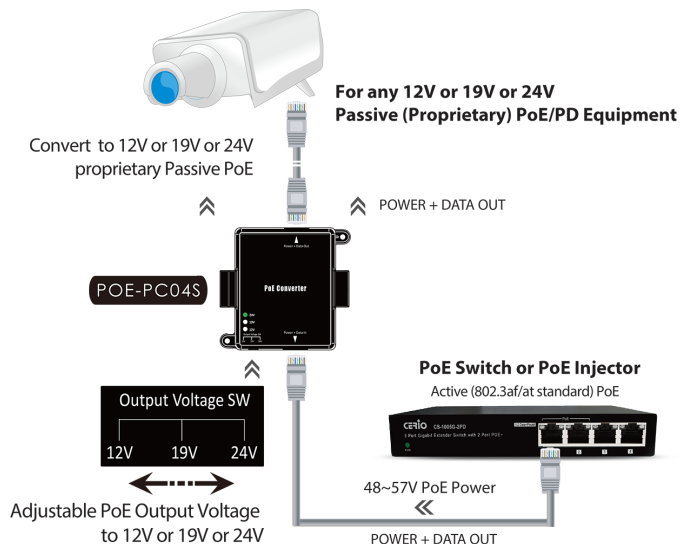

## PoE Converter for Active PoE Converter to Passive PoE

### Highlight Features

- Complying with IEEE 802.3 10Base-T, IEEE 802.3u 100Base-TX, IEEE 802.3ab 1000Base-T IEEE 802.3at PoE+, IEEE 802.3af PoE standards
- PoE (PD) support IEEE 802.3at active PoE+, IEEE 802.3af PoE, Max power input support 30Watt
- Supports 2ports 10/100/1000Mbps Gigabit Ethernet
- Supports passive PoE output voltage and hot switching for 12V / 19V /24V three range adjustable
- With hardware protection design the device will not cause any damage while changing the voltage output during operation.
- Up to 100 meters (328 feet) application
- Supports to Short-circuit Protection
- Plug and Play, no software require .
- Supports desktop or wall mounting installation and multiple units combination for easy to bundles organize the Ethernet cables

## Installation

### Before Installation

The POE-PC04S is designed to provide a compatible solution for proprietary passive PoE (non standard active PoE) devices. If the device is generally POE-PC04S can be used with any 802.3af/at PoE switch to convert standard PoE power to Passive PoE power.

The POE-PC04S converts the power supply and provides three Passive PoE power outputs through the DIP switch. The voltage and current are as follows:

### DIP Switch :

- 12 VDC / 2.25A (Max)
- 19 VDC / 1.42A (Max)
- 24 VDC / 1.125A (Max)



### Cables Installation

POE-PC04S provides a POE-powered solution for proprietary passive 12/19/24V PoE devices. The setup of the Converter can be performed using the following steps:

- Connect from "Power+Data out" of POE-PC04S to the RJ-45 port of the remote (Passive PoE) device.
- RJ45 Cable connect first power source that the "Power+Data in" Port of the converter is fully connected to the 802.3at source-powered PoE Injector or PoE Switch.

**Caution: Please ensure the output voltage is correct for remote (Passive PoE) device. Otherwise it will damage your remote device.**

- Power on the remote device and the LED for voltage status indicator on POE-PC04S will remains on.

### Units Combination

This device can be locked on the wall, **(Does not have screw attachment , you must prepare it yourself)** or it can be combined with multiple units for easy to bundles organize the Ethernet cables.

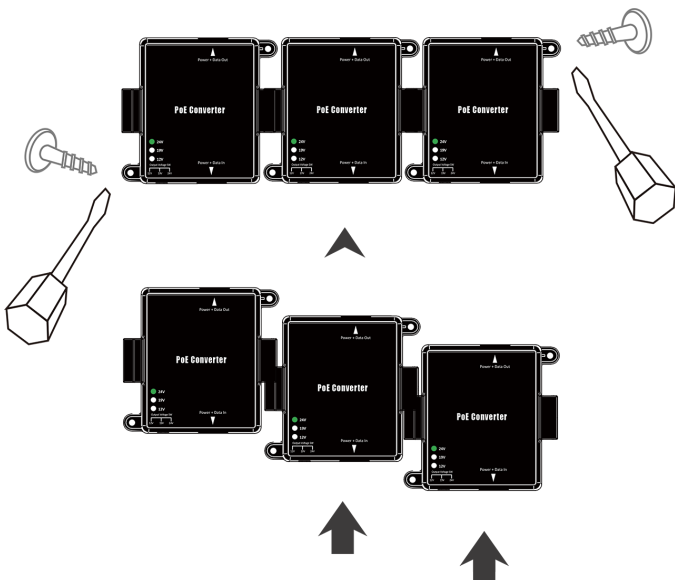

## LED Indicator :

Output power switching (PoE 12V/ PoE 19V/ PoE 24V)

LED indicators for Power function enable

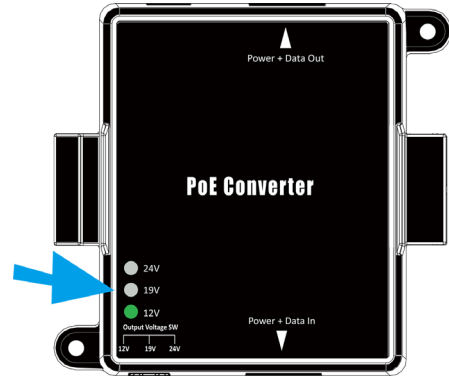

LED Definition	
	● Passive 12V PoE output: 12V Light on
	● Passive 19V PoE output: 19V Light on
	● Passive 24V PoE output: 24V Light on

## Product Specifications

### Standards & Hardware Specifications

<b>Standard</b>	IEEE802.3 10BASE-T IEEE802.3u 100BASE-TX IEEE 802.3ab 1000BASE-T IEEE802.3at Power over Ethernet (PoE+) IEEE802.3af Power over Ethernet (PoE)
<b>Network Media</b>	10BASE -T: UTP Cat. 3 or up 100BASE-TX : UTP Cat. 5 or up 1000BASE-T: UTP Cat. 5 or up
<b>Data Transfer Rate</b>	10/100/1000Mbps (Half-duplex), 20/200/2000Mbps (Full-duplex)
<b>Data PIN</b>	PIN 1/2, 3/6 & 4/5, 7/8
<b>Power PIN</b>	Input : End-span (Type-A): PIN 1/2,3/6 ; Mid-span (Type-B): PIN 4/5,7/8 Output : Mid-span (Type-B): PIN 4/5,7/8
<b>Data In</b>	Connects PC/HUB/Switch
<b>Ethernet Connector</b>	RJ-45 x1 for Active PoE Power + Data input RJ-45 x1 for Passive PoE Power + Data output
<b>ESD Protection</b>	Over Voltage protection & Short Circuit Protection

### Environmental & Mechanical Characteristics

<b>Max Power Output</b>	27Watts
<b>Power Interface</b>	Output to 12V or 19V or 24V passive PoE device
<b>Power Requirement</b>	802.3af/at PoE Power Source
<b>PoE Input Voltage</b>	48V~57V
<b>DC Output Control Range</b>	12V/19V/24V three range adjustable by DIP switch
<b>DC Output Current</b>	Max 12V/2.25A , 19V/1.42A, 24V/1.125A
<b>LED Indicators</b>	Passive PoE Output LED x3 : 12V or 19V or 24V
<b>Operating Temperature</b>	0° to 55° C
<b>Storage Temperature</b>	-40° to 70° C
<b>Operating Humidity</b>	10% to 90% non-condensing
<b>Storage Humidity</b>	5% to 90% non-condensing
<b>Dimension</b>	84.5 x 80 x 39.5mm ( W x D x H )
<b>Unit Weight</b>	97.6g
<b>Case of Materials</b>	ABS
<b>Production Location</b>	TW Only
<b>Certification</b>	FCC, CE, RoHS-compliant