

LP-300

2.4GHz / 5GHz / 6GHz N-Female to N-Male Lightning Protector

EAN Codes: 4712757151930



Introduction

The **CERIO LP-300** N-Jack (female) to N-Jack (male) is a lightning surge protector for 2.4GHz, 5GHz, and 6GHz networks. With power dissipation as low as 0.18dB (2.4GHz), 0.26dB (5GHz), and 0.32dB (6GHz), it can be connected to 2.4GHz, 5GHz, and 6GHz outdoor antennas and network devices (APs, routers, and bridges). When outdoor wireless devices (such as outdoor wireless APs or their outdoor antennas) are struck by lightning, the **LP-300**'s internal varistor and integrated design effectively absorb and conduct transient voltage surges caused by direct or indirect lightning strikes, protecting the device's circuitry from damage. For outdoor wireless APs, the **LP-300** is an ideal protection option. With its ability to effectively absorb, guide, and block direct and indirect lightning strikes at an affordable price, the **LP-300** provides comprehensive protection for your outdoor wireless devices. The **CERIO LP-300** lightning arrester can be easily deployed in a variety of wireless long-range applications, including antennas, cables, and other accessories for 2.4GHz/5GHz/6GHz outdoor wireless applications.

Highlight Features

- 2.4GHz / 5GHz / 6GHz Frequency range
- RF Low Loss
 - @ 2.4GHz : Total Loss 0.15dB
 - @ 5GHz : Total Loss 0.26 dB
 - @ 6GHz : Total Loss 0.32 dB

Hardware Overview

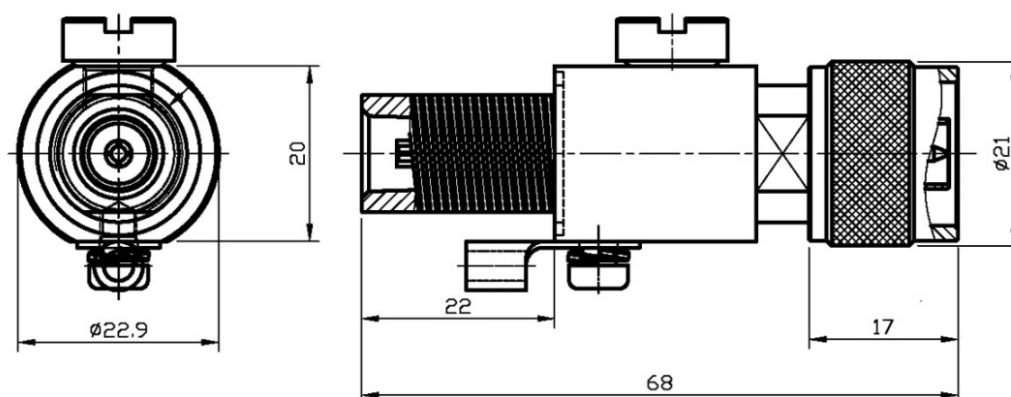

Hardware Specifications

| |
|-----------------------------------|
| Connector Type |
| N-Jack(female) to N-Jack(male) |
| Frequency |
| 0~7 GHz |
| V.S.W.R : |
| 1 : 3 (Max) |
| Impedance |
| 50 Ohms |
| Gas Tube DC |
| 230V \pm 20% |
| Gas Tube Impulse Resistance |
| \geq 10000 Ohms |
| AC Current |
| 10A /1s , 30A/ 9 cycles (@50Hz) |
| Surge Current |
| 10KA (@8/20 μ s) |

| |
|---------------------------|
| Operating Temperature |
| -50°C - + 90°C |
| Storage Temperature |
| -50°C - + 90°C |
| Humidity |
| 100% Non- Condensing |
| Dimensions |
| 68 * 30 * 22.9 mm(L*H *W) |
| Weight |
| 122g |
| Production Location |
| TW |

Package Contents

| |
|------------------|
| Content |
| LP-300 Main unit |